

In-ceiling Speaker

MAIN FEATURES

- 2-way loudspeaker configuration
- 8" LF woofer and 0.5" HF driver
- 70V/100V multitap line transformer or 8 ohm
- Frequency response from 50Hz to 18kHz
- MAX SPL (100V/10W): 102dB
- Transformer taps 40/20/10/5W
- Dog-ears mounting system
- ABS in white RAL 9016 and powder-coated iron grille

DESCRIPTION

The ceiling speaker CSL 840TIC is a 2-way loudspeaker configuration with a 8" LF woofer and 0.5" HF driver. The CSL 840TIC meets the following performance criteria: capable of achieving 102dB SPL, a frequency response from 50Hz to 18kHz, and a multitap (40/20/10/5W) line transformer (70/100V) or 8 Ohm. It features a compact size and excellent acoustic performance. The CSL 840TIC has a body made of ABS and a powder-coated iron grille in white RAL 9016. The Dog-ears mounting system, a particular fixing system, allows for a significant reduction in installation time.



TECHNICAL SPECIFICATIONS

GENERAL

Code	White	29418
Configuration	way	2
Low frequency woofer	inch	8
High frequency driver	inch	0.5

ACOUSTIC SPECIFICATIONS

Frequency response	Hz	50 - 18k
Sensitivity (@1W/1m)	dB	88 ± 3
Dispersion	H°x V°	90 conical
MAX SPL (100V/10W)	dB	102
Line input	V	70 / 100

AMPLIFIER

Rated power	W	40
Nominal impedance	Ohm	8
Transformer taps	W	40 / 20 / 10 / 5

MECHANICAL SPECIFICATIONS

Material	Cabinet	ABS
	Grille	Powder-coated iron
Net dimensions (WxHxD)	mm	ø270 x 185
	inch	ø10.63 x 7.28
Net weight	kg	3.10
	lb	6.83

DIMENSIONAL DRAWING

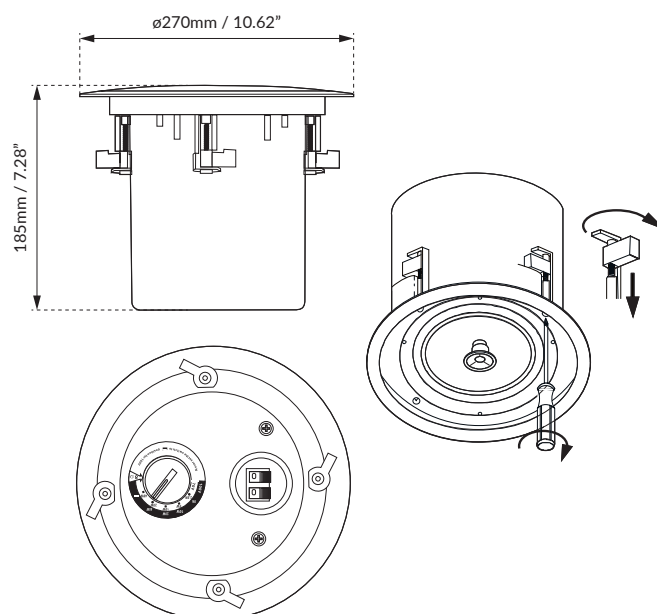

FREQUENCY RESPONSE DIAGRAMS

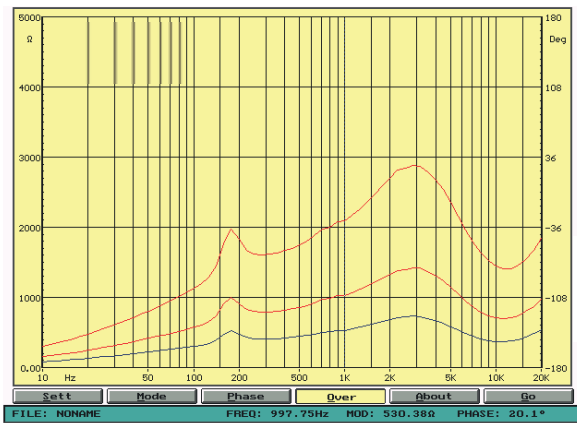
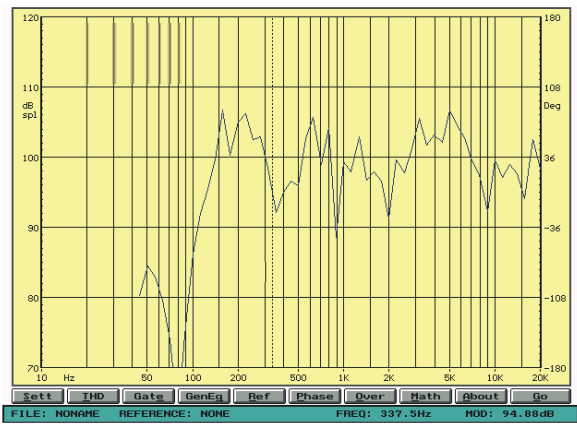

POLAR RESPONSE DIAGRAMS

