

In-ceiling Speaker

MAIN FEATURES

- 2-way loudspeaker configuration
- 6" LF woofer and 0.5" HF driver
- 70V/100V multitap line transformer or 8 ohm
- Frequency response from 90Hz to 20kHz
- MAX SPL (100V/15W): 102dB
- Transformer taps 30/15/7.5/3.8W
- Dog-ears mounting system
- ABS in white RAL 9016 and powder-coated iron grille

DESCRIPTION

The ceiling speaker CSL 630TIC is a 2-way loudspeaker configuration with a 6" LF woofer and 0.5" HF driver. The CSL 630TIC meets the following performance criteria: capable of achieving 102dB SPL, a frequency response from 100Hz to 20kHz and a multitap line transformer (70/100V) or 8 Ohm. It features a compact size and excellent acoustic performance. The CSL 630TIC has a body made of ABS and a powder-coated iron grille in white RAL 9016. The Dog-ears mounting system, a particular fixing system, allows for a significant reduction in installation time.



TECHNICAL SPECIFICATIONS

GENERAL

Code	White	29417
Configuration	way	2
Low frequency woofer	inch	6
High frequency driver	inch	0.5

ACOUSTIC SPECIFICATIONS

Frequency response	Hz	90 - 20k
Sensitivity (@1W/1m)	dB	88 ± 3
MAX SPL (100V/15W)	dB	102
Line input	V	70 / 100

AMPLIFIER

Rated power	W	30
Nominal impedance	Ohm	8
Transformer taps	W	30 / 15 / 7.5 / 3.8

MECHANICAL SPECIFICATIONS

Material	Cabinet	ABS
	Grille	Powder-coated iron
Net dimensions (WxHxD)	mm	ø230 x 150
	inch	ø9.06 x 5.91
Net weight	kg	2.30
	lb	5.07

DIMENSIONAL DRAWING

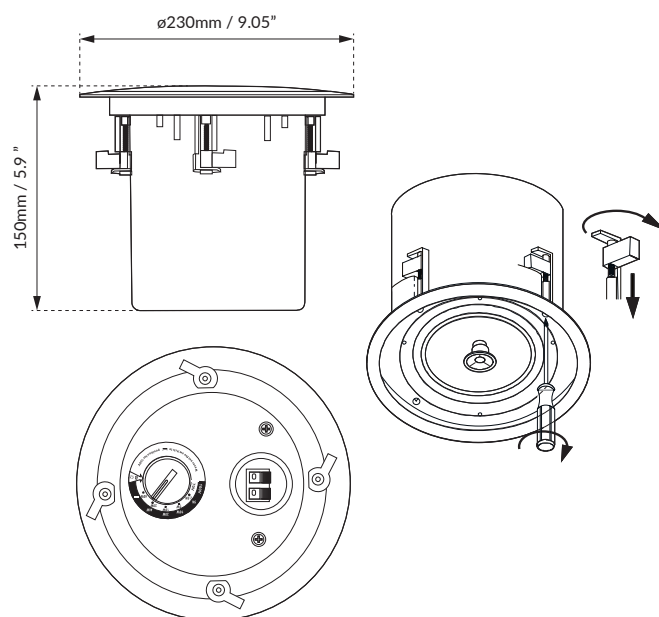

FREQUENCY RESPONSE DIAGRAMS

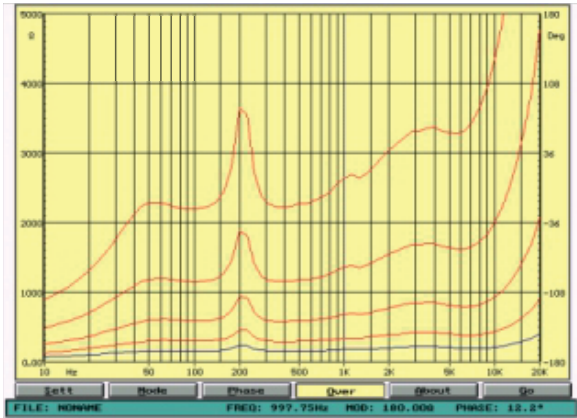
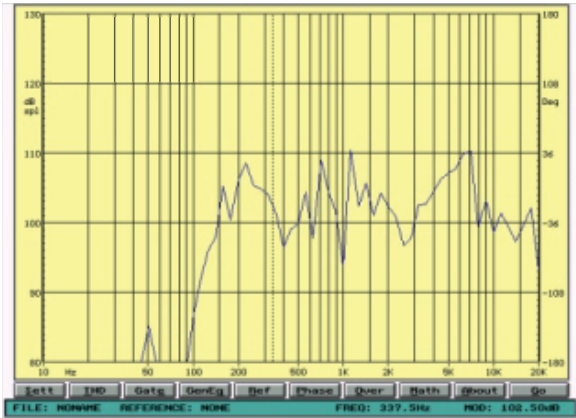

POLAR RESPONSE DIAGRAMS

